

Conference Kick Off ITFM Peer Discussion: Governments and Universities

World of IT Financial Management 2024 St. Paul

Penny Collen

pennylcollen@aol.com



- This session is an opportunity for those from governments and universities to place a name with a face, to identify who has similar responsibilities as yourself, and who is facing the same challenges at work as you face in an environment with unique needs and requirements. Attendees will be asked to describe their major work-related issues, challenges and problems at this session so you can find others with similar concerns.



Conference Logistics



Conference Handouts
Conference Speakers
Session Details
Speaker Handouts Online access

www.itfma-stpaul.com

Attendee List
Speaker Evaluation Forms

MAIN LEVEL

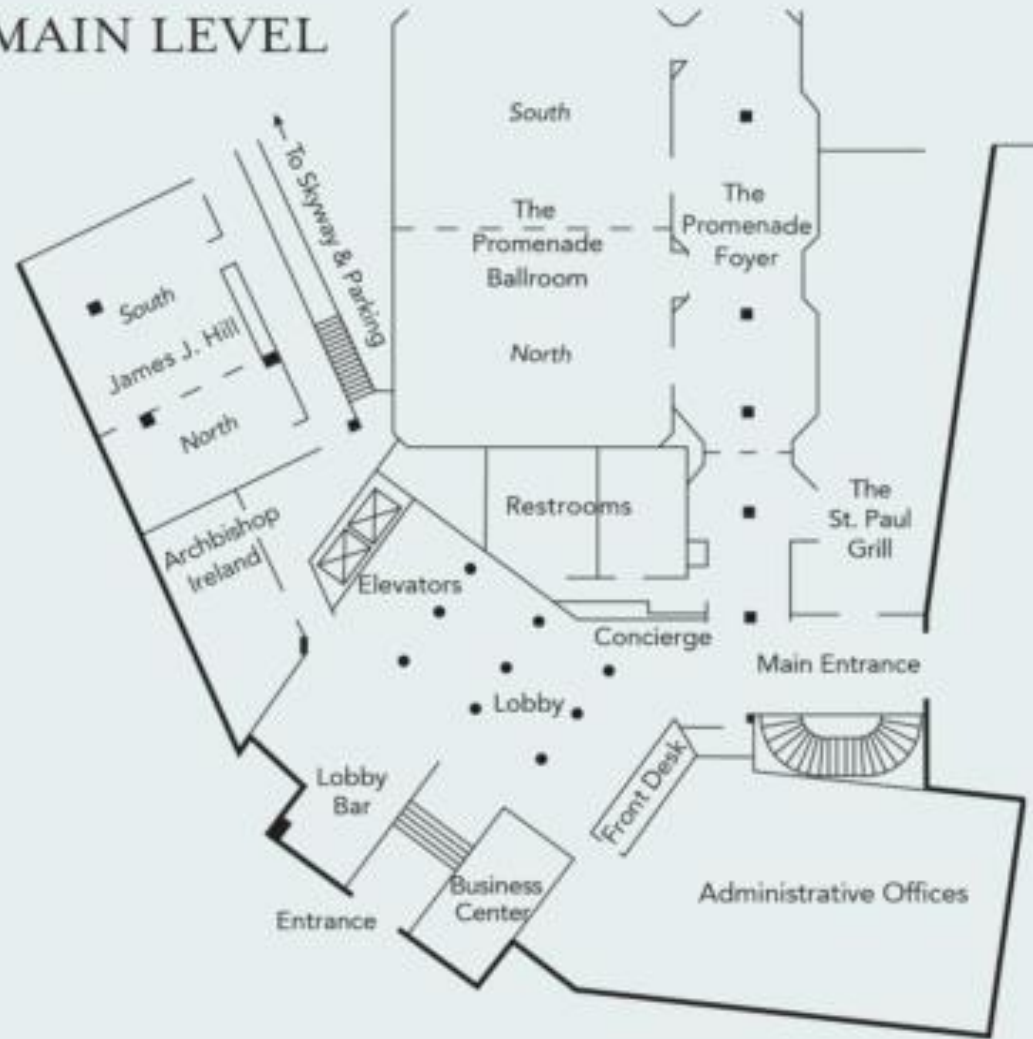

LOWER
LEVEL

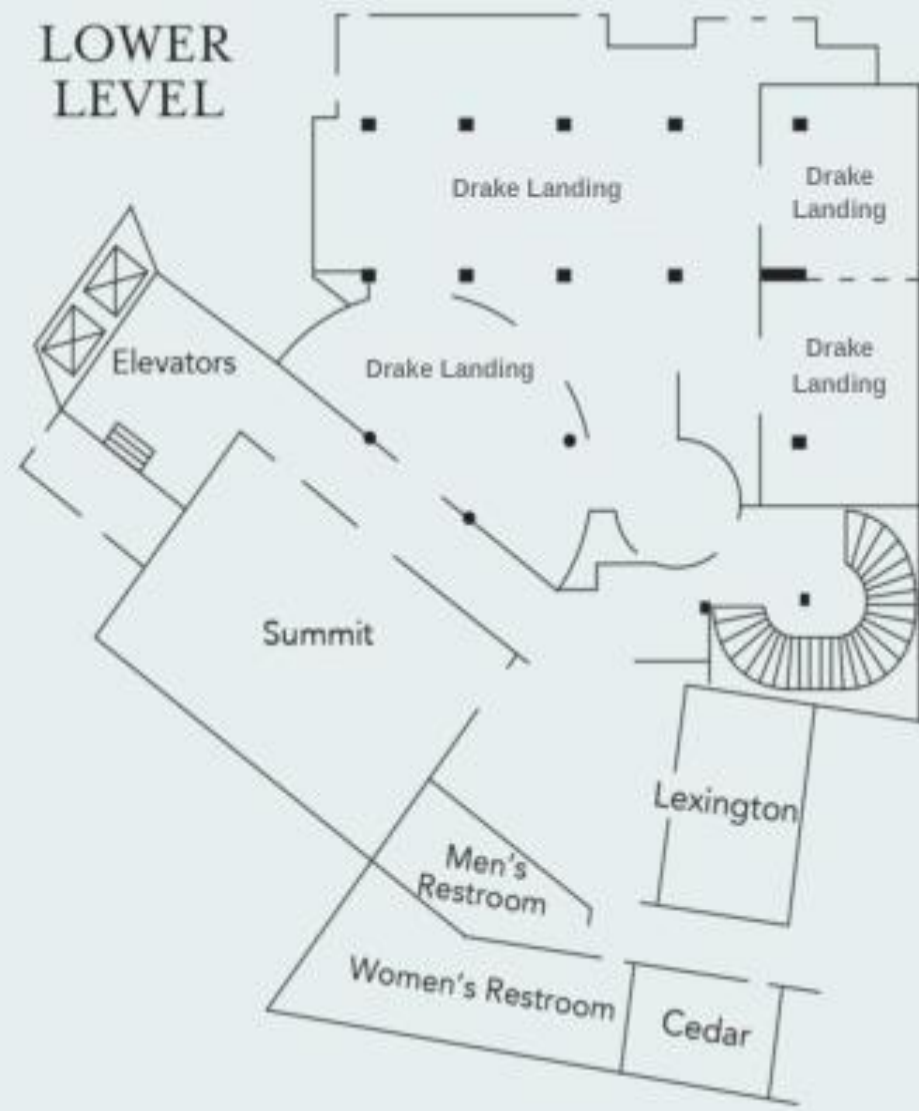

Important things to know

Hotel Layout

Registration	Outside of Promenade Foyer
Breaks	Promenade Foyer
Open Bar (M-Th)	Promenade Foyer
Exhibitors	Promenade Foyer
Breakfast\Lunch	Promenade North Ballroom
Meeting	Promenade South Ballroom
Meeting	James J. Hill Room
Meeting	Summit Room (Lower Level)

Note: All on Main Level with the exception of Summit Room meetings, which will have its own refreshment station for the breaks

•

Important things to know

Hotel Layout

Registration

Outside of Promenade Foyer

Breaks

Promenade Foyer

Open Bar (M-Th)

Promenade Foyer

Exhibitors

Promenade Foyer

Breakfast\Lunch

Promenade North Ballroom

Meeting

Promenade South Ballroom

Meeting

James I. Hill Room

Meeting

Summit Room (Lower Level)

Note: All on Main Level with the exception of Summit Room meetings, which will have its own refreshment station for the breaks

•

MAIN LEVEL

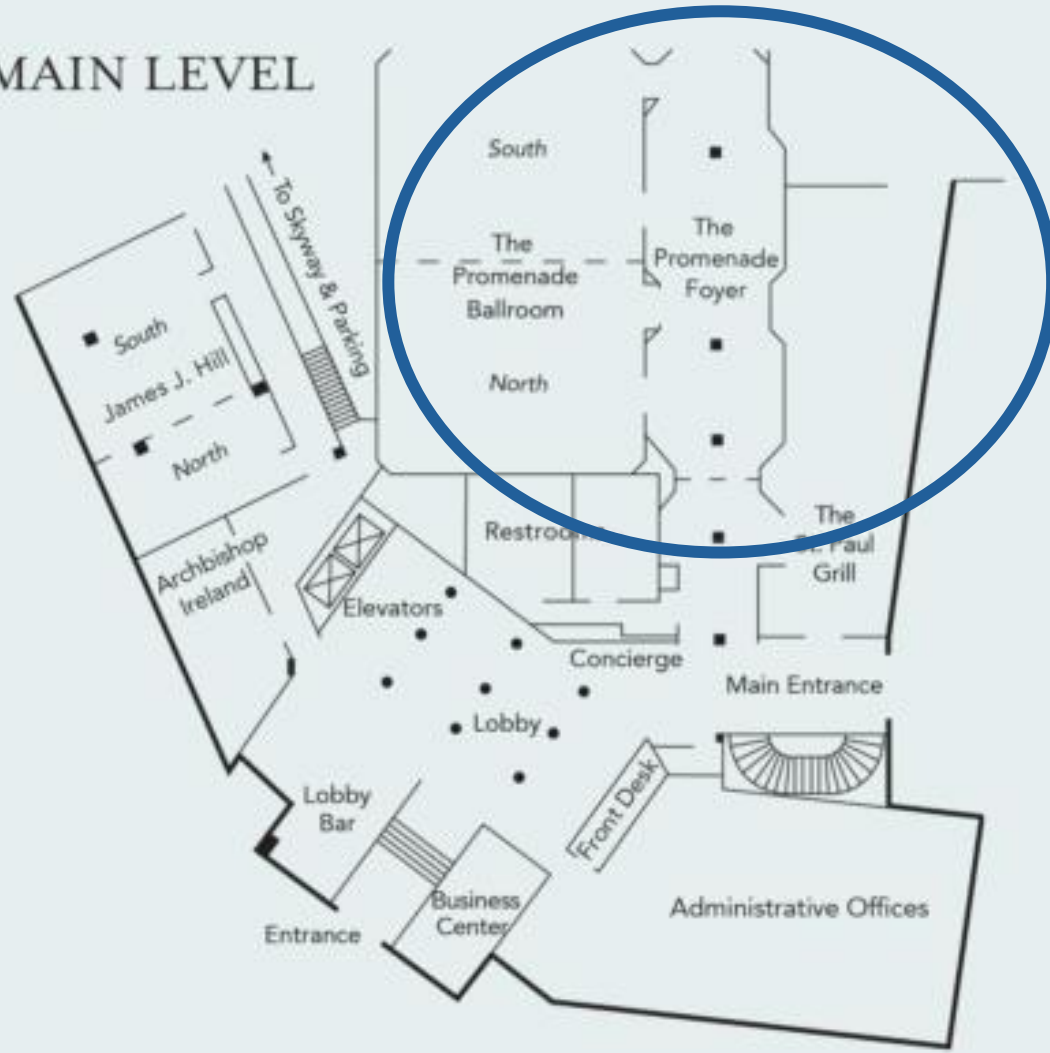

Meals, Breaks



Important things to know

Hotel Layout

Registration	Outside of Promenade Foyer
Breaks	Promenade Foyer
Open Bar (M-Th)	Promenade Foyer
Exhibitors	Promenade Foyer
Breakfast/Lunch	Promenade North Ballroom

Meeting
Meeting
Meeting

Promenade South Ballroom
James J. Hill Room
Summit Room (Lower Level)

Note: All on Main Level with the exception of Summit Room meetings, which will have its own refreshment station for the breaks

•

Meeting Rooms



LOWER LEVEL



Lower Level Meeting Room (Summit)



Fun Facts about the Hotel

- The national historic landmark Saint Paul Hotel has stood unrivaled as the best luxury hotel in the Twin Cities since 1910. The hotel has hosted some of America's preeminent figures including presidents, royalty, celebrities, and gangsters. Charles Lindberg returned to St. Paul from his trans Atlantic flight in 1927 and a dinner is given for him at the hotel. During St. Paul's gangster era (1920s-1930s), Leon Gleckman, known as the "Al Capone of St. Paul," maintains his headquarters for business dealings in a suite at The Saint Paul Hotel. Mike Malone, a U.S. Treasury Department official who infiltrated Al Capone's syndicate in Chicago, also rents a room at the hotel to observe Gleckman's activities. A young band leader named Lawrence Welk began playing in the hotel on Saturday nights in 1937. Gene Autry checks into the hotel for eight days in 1947 with his horse, Champion, for a rodeo.

Conference Logistics



As a courtesy to speakers and other attendees, please Turn off cell phones while in sessions.

Conference Logistics



As a representative of
Governments or Universities,
what are the challenges you are
facing? What topics would you
most like to hear about?